

| | Fan Size/Qty | | | | | | | |
|-------------------------|--------------|----|----|----|----|----|----|----|
| | 21 | 24 | 30 | 36 | 42 | 48 | 54 | 60 |
| Panel End Assy, Male | 1 | 1 | 1 | 1 | 1 | 1 | 1 | 1 |
| Panel End Assy, Female | 1 | 1 | 1 | 1 | 1 | 1 | 1 | 1 |
| Hood Panel | 2 | 3 | 5 | 5 | 6 | 7 | 8 | 9 |
| Hood Side Rail Assy | 2 | 2 | 2 | 2 | 2 | 2 | 2 | 2 |
| Filter Rail Assy, Long | 2 | 2 | 2 | 2 | 2 | 2 | 2 | 2 |
| Filter Rail Assy, Short | 0 | 2 | 2 | 2 | 2 | 2 | 2 | 2 |
| Filter Rail | 2 | 2 | 2 | 2 | 2 | 2 | 2 | 2 |
| Hood Gusset | 0 | 0 | 4 | 4 | 4 | 4 | 4 | 4 |
| Stiffener Angle | 2 | 2 | 2 | 2 | 2 | 2 | 2 | 2 |
| Filter Stop Plate | 2 | 2 | 2 | 2 | 2 | 2 | 2 | 2 |
| Hood Clip | 0 | 0 | 0 | 0 | 0 | 0 | 18 | 20 |
| Hood Mount Bar | 2 | 2 | 2 | 2 | 2 | 2 | 2 | 2 |
| Filter Size A | 4 | 6 | 8 | 8 | 8 | 10 | 10 | 10 |
| Filter Size B | 2 | 4 | 4 | 4 | 4 | 4 | 8 | 8 |

| HDWRKIT-LH01 | Hardware Kit #1 - Hood |
|--------------|-----------------------------------------------|
| Qty | Item |
| 12 | Cap Screw, Serrated Flange Hex, 3/8-16 x .75 |
| 20 | Hex Nut, Serrated Flange, 3/8-16 |
| 4 | Cap Screw, Serrated Flange Hex, 3/8-16 x 1.25 |
| 72 | Screws, #12 |

| HDWRKIT-LH07 | Hardware Kit #7 - Filter Rail |
|--------------|-------------------------------------------|
| Qty | Item |
| 22 | Cap Screw, Serrated Flange, 5/16-18 x .75 |
| 16 | Hex Nut, Serrated Flange, 5/16-18 |
| 6 | Nut Clips, 5/16 |

- Fan sizes 21 to 36 are shipped fully assembled, unless otherwise specified.
- A minimum of two people are required for assembly. Before starting, review these instructions.
- The following tools are required:
 - Powered screwdriver (preferred) or drill
 - 3/8, 7/16, 1/2, 9/16 wrenches and sockets
 - 5/16" nut driver bit for powered screwdriver
 - Awl, for hole alignment

Inspect for missing or damaged parts

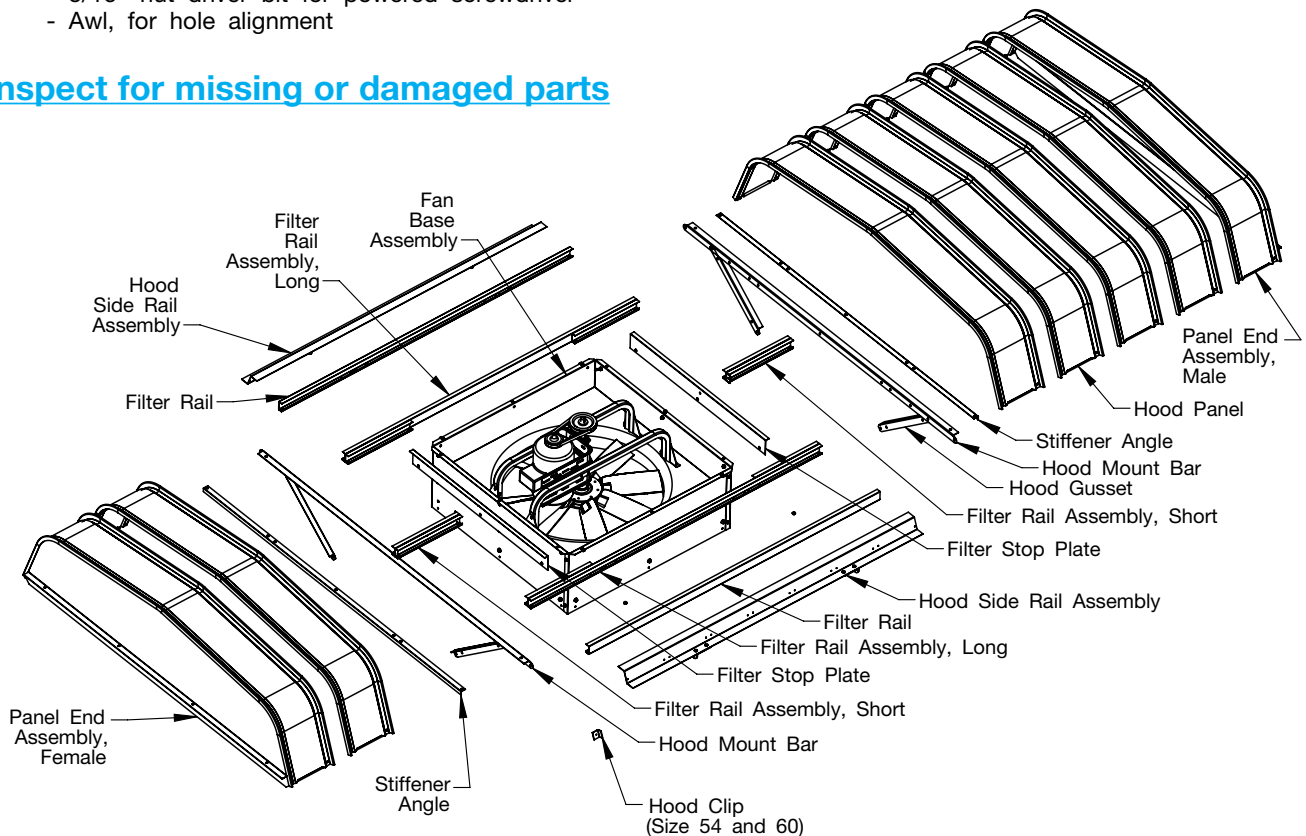

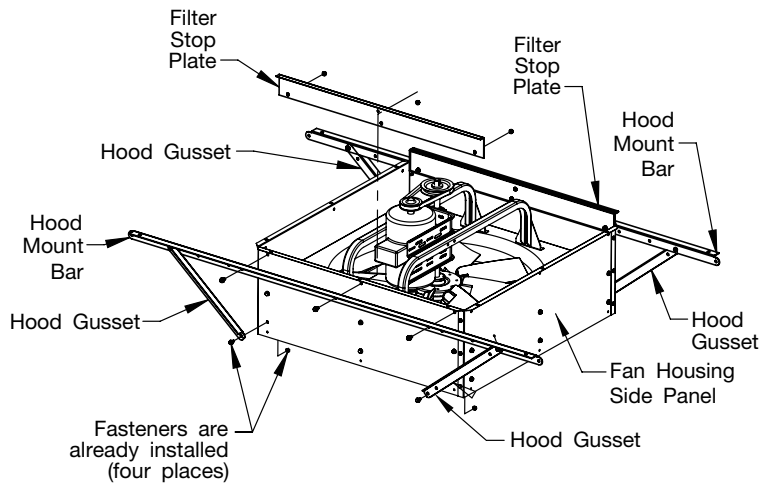

Step 1 – Install Hood Mount Bars and Filter Stops

Fasteners (Kit #1):

Cap Screw, Serrated Flange, 3/8-16 x 0.75
Hex Nut, Serrated Flange, 3/8-16

- Assemble Hood Mount Bars and Filter Stop Plates on both sides of the fan housing, using cap screws and nuts.
- Assemble four Hood Gussets using cap screws and nuts. The lower fasteners on the gussets attach to the curb stop fasteners, which are already installed on the fan housing. One at a time, remove the screws and attach the gussets.

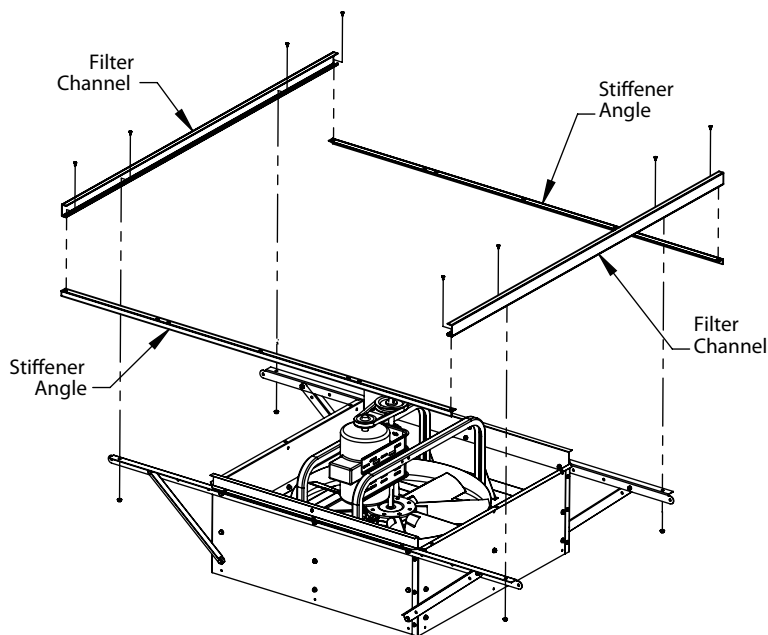

Step 2 – Install Filter Channels and Stiffeners

Fasteners (Kit #7):

Cap Screw, Serrated Flange, 5/16-18 x 0.75
Hex Nut, Serrated Flange, 5/16-18

- Assemble two Filter Channels to Hood Mount Bars using cap screws and nuts.
- Assemble two Stiffener Angles to the Filter Channels using cap screws and nuts.

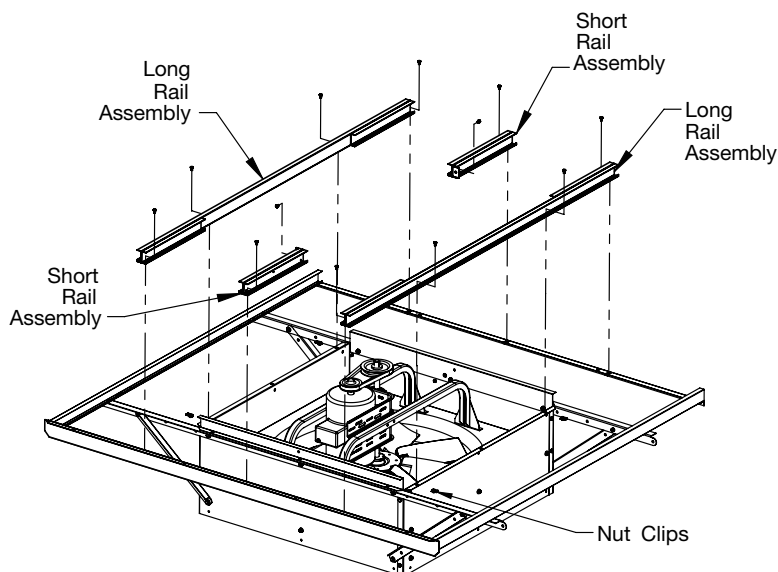

Step 3 – Install Filter Rail Assemblies

Fasteners (Kit #7):

Cap Screw, Serrated Flange, 5/16-18 x 0.75
Hex Nut, Serrated Flange, 5/16-18
Nut Clip, 5/16-18

- Install nut clips onto the fan Housing Side Panel flanges as shown.
- Assemble two Long Rail Assemblies using cap screws and nuts.
- Assemble two Short Rail Assemblies using cap screws and nuts.

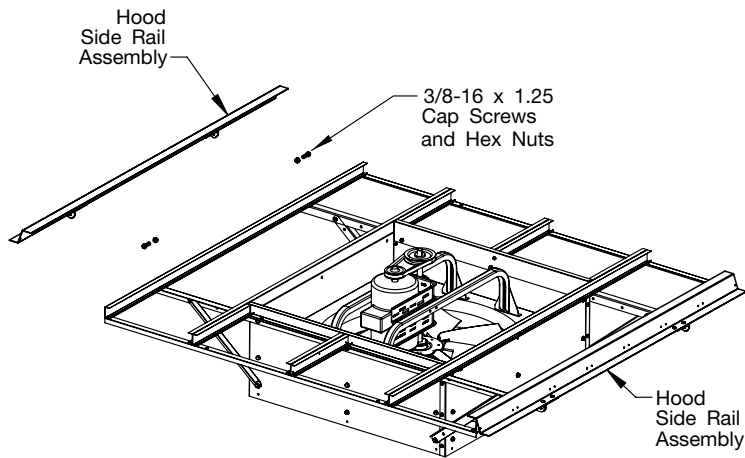

Step 4 – Install Hood Side Rails

Fasteners (Kit #1):

Cap Screw, Serrated Flange, 3/8-16 x 1.25
Hex Nut, Serrated Flange, 3/8-16

- A. Install two Hood Side Rail Assemblies to the Hood Mount Bars using cap screws and nuts. Do not fully tighten fasteners. They will be tightened in Step 7.

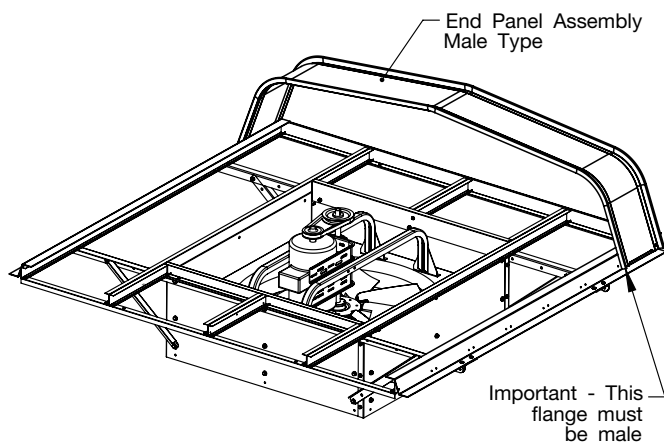

Step 5 – Install End Assy (Male)

Fasteners (Kit #1):

Screws, #12

- A. Assemble End Panel Assembly (male type) using two #12 screws.

End View of Panel

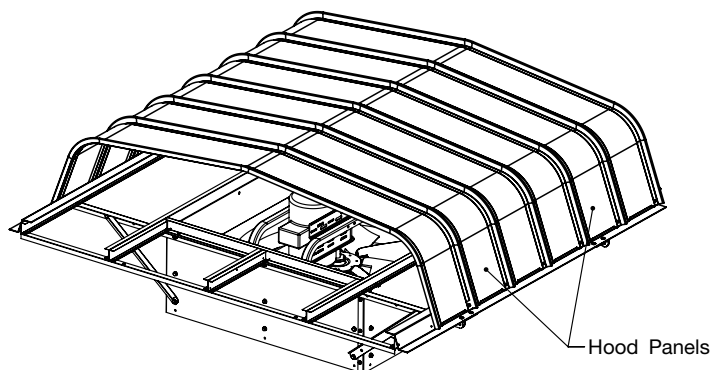
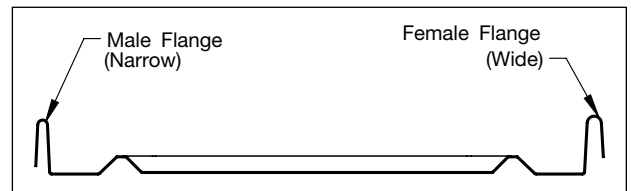

Step 6 – Install Hood Panels

Fasteners (Kit #1):

Screws, #12

- A. Install the Hood Panels using #12 screws.
B. On Sizes 54 and 60, hood clips must be installed at each interlocking rib while installing the panels. Position the Hood Panel in place and reach underneath to slide the clip into place.

**For Sizes 54 and 60,
install hood clips at each rib.**

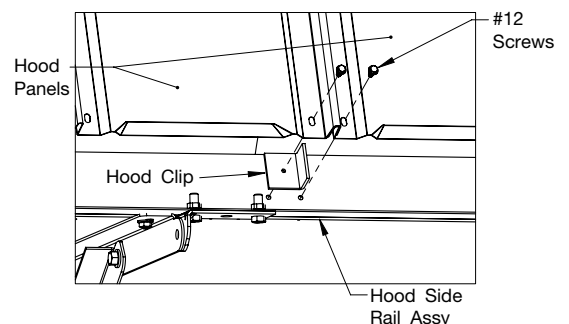

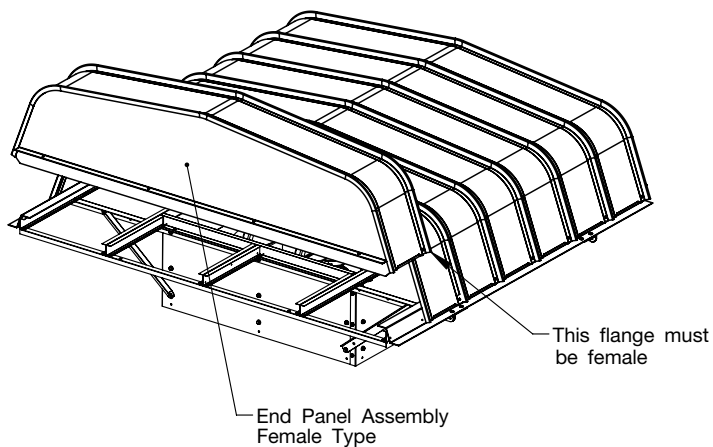

Step 7 – Install End Assembly (Female)

Fasteners (Kit #1):
Screws, #12

- Assemble End Panel Assembly (female type) using four #12 screws. On sizes 54 and 60, install hood clips at flange joints.
- Fully tighten the Hood Mount Bar/Side Rail fasteners from Step 4.

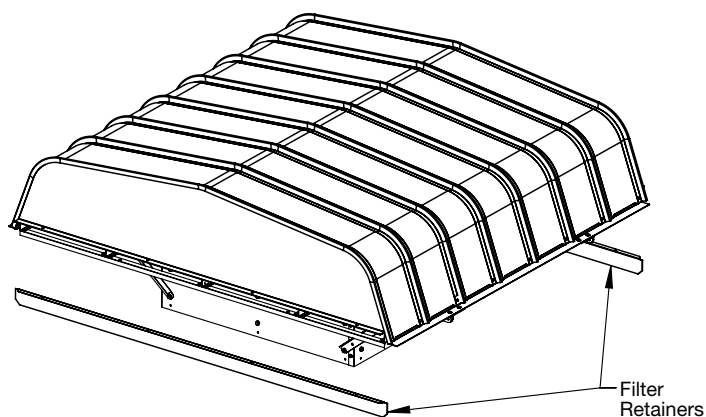

Step 8 – Install Filters

- Remove both Filter Retainers from End Panels. Retain hardware.
- Install Filters as shown.
- Reinstall both Filter Retainers.

Filter Configurations

Fan Size 21

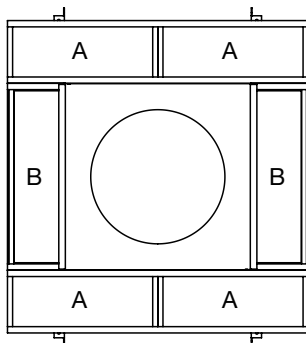

Fan Size 24 to 48
(Check table for quantities)

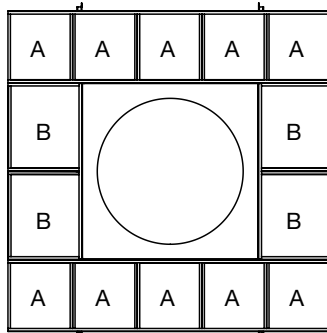

Fan Size 54 to 60

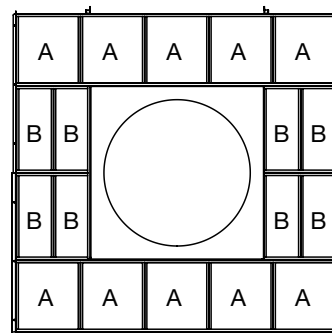

| Fan Size | Filter A | | | Filter B | | |
|----------|---------------|---------------|----------|---------------|---------------|----------|
| | P/N | Size | Quantity | P/N | Size | Quantity |
| 21 | FILTER2A-LH21 | 23.81 x 9.75 | 4 | FILTER2B-LH21 | 29.19 x 8.88 | 2 |
| 24 | FILTER2A-LH24 | 19.88 x 13.50 | 6 | FILTER2B-LH24 | 16.00 x 13.38 | 4 |
| 30 | FILTER2A-LH30 | 20.88 x 15.50 | 8 | FILTER2B-LH30 | 20.00 x 21.06 | 4 |
| 36 | FILTER2A-LH36 | 20.81 x 20.50 | 8 | FILTER2B-LH36 | 23.00 x 18.25 | 4 |
| 42 | FILTER2A-LH42 | 23.81 x 17.00 | 8 | FILTER2B-LH42 | 26.00 x 21.38 | 4 |
| 48 | FILTER2A-LH48 | 21.44 x 23.50 | 10 | FILTER2B-LH48 | 29.00 x 24.38 | 4 |
| 54 | FILTER2A-LH54 | 23.88 x 26.50 | 10 | FILTER2B-LH54 | 32.13 x 13.69 | 8 |
| 60 | FILTER2A-LH60 | 26.25 x 29.50 | 10 | FILTER2B-LH60 | 35.00 x 15.00 | 8 |



TWIN CITY FAN & BLOWER | WWW.TCF.COM

5959 Trenton Lane N | Minneapolis, MN 55442 | Phone: 763-551-7600 | Fax: 763-551-7601